

## BEST PRACTICES

- Rinse after every suctioning
- Change suction catheter every 72 hours
- Change manifold when necessary (IFU)
- Connect pink saline vial before and after every suctioning
- Do not use suction catheter or seal cassette to move the manifold. Instead, use the dial like a steering wheel.



Rotating manifold locks into place with a CLICK for reassurance that circuit remains sealed.

Clinicians can perform suctioning and other procedures such as bronchoalveolar lavage, bronchoscopy, or MDI drug delivery while maintaining a closed vent circuit as recommended can prevent Ventilator Associated Pneumonia (VAP).

## BEST PRACTICES

### SET-UP THE CLOSED SUCTION SYSTEM

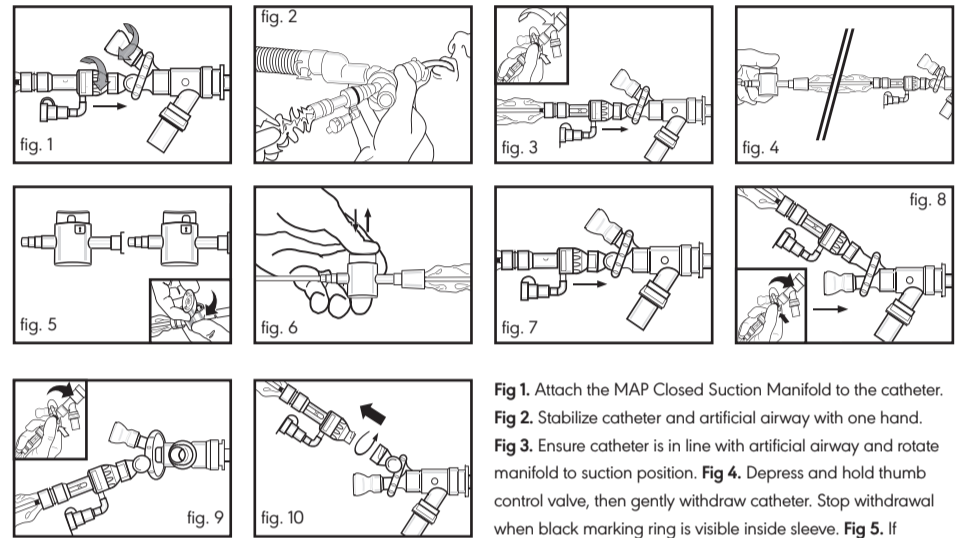
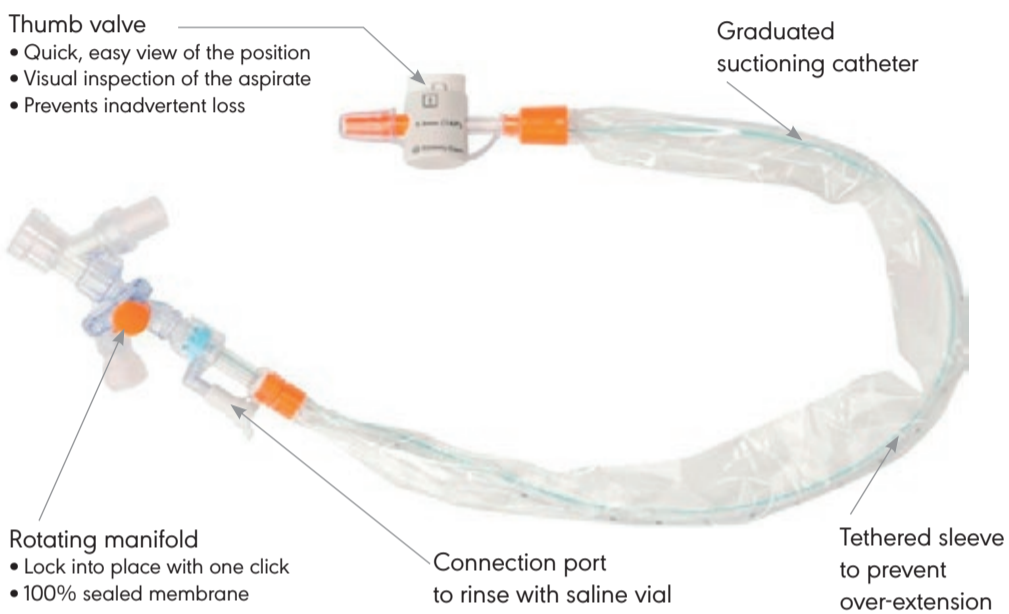

**Fig 1.** Attach the MAP Closed Suction Manifold to the catheter. **Fig 2.** Stabilize catheter and artificial airway with one hand. **Fig 3.** Ensure catheter is in line with artificial airway and rotate manifold to suction position. **Fig 4.** Depress and hold thumb control valve, then gently withdraw catheter. Stop withdrawal when black marking ring is visible inside sleeve. **Fig 5.** If necessary, lock thumb control valve when not suctioning to prevent inadvertent or accidental activation. **Fig 6.** Intermittently depress and release thumb valve. **Fig 7.** Advance catheter until the sum appears in the window to control depth suction. **Fig 8.** For Alternate therapy: Depress plunger button and rotate MAP Closed Suction Manifold so the Alternate Therapy Port is in-line with the airway, open seal cassette, insert instrument and perform procedure. **Fig 9.** Ensure the MAP Closed Suction Manifold is rotated to the Off Position to change the catheter with a Replacement Catheter. **Fig 10.** Detach by rotating Replacement Catheter counter-clockwise.

## SET-UP THE CLOSED SUCTION SYSTEM

### HOW TO

#### HOW TO SUCTION:

1. Verify suction is working
2. Check that manifold is in SUCTION position
3. Pre-connect pink saline vial
4. Advance suction catheter
5. Press thumb valve for at least three seconds
6. Slowly retract suction catheter until black marker on sheath is visible and catheter tip is visible in the chamber
7. Remove empty saline vial and lock thumb valve
8. After suctioning, leave manifold in SUCTION or NEUTRAL position (depending on unit protocol)

Note: if immediately performing another suctioning, you do not need to change manifold setting

#### HOW TO CHANGE CATHETER:

1. Change manifold to NEUTRAL position by pressing button and turning until you hear a 'click'
2. Detach by rotating the catheter counter-clockwise.
3. Replace with new catheter by inserting catheter and rotating clockwise until a snug fit is reached.
4. Once procedure is complete, turn manifold to SUCTION position (depending on unit protocol)

#### HOW TO PERFORM BRONCHIAL SAMPLING:

1. Change manifold to SAMPLING position by pressing button and turning until you hear a 'click'
2. Open seal-cassette and lubricate bronchoscope
3. Insert bronchoscope, PDP or Mini-BAL
4. Once procedure is complete, turn manifold to SUCTION or NEUTRAL position (depending on unit protocol)
5. Remove and replace used seal-cassette

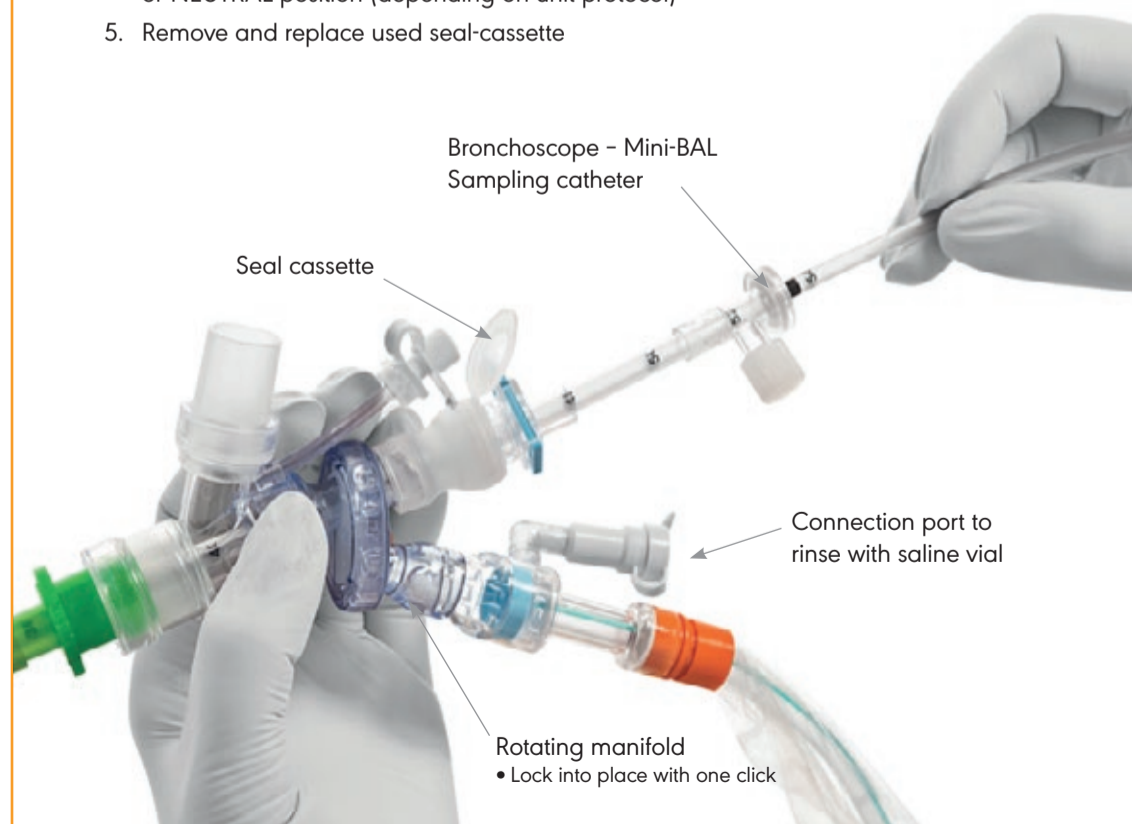

## HOW TO SUCTION / CHANGE CATHETER / PERFORM BRONCHIAL SAMPLING

---

**AVANOS**

For more information, please send an email to [customerservice.uk.ie@avanos.com](mailto:customerservice.uk.ie@avanos.com) or visit [www.avanos.co.uk](http://www.avanos.co.uk).